

## L 262 S



Art.-No.: **alu-silver 646417**



Art.-No.: **alu-anthracite 646519**

**Modern and timeless.  
In superb quality.**

The accomplished composition of hand-blown opal glass shade and light arm cuts an impressive figure with a surface finish that leaves no margin of doubt. But that's not all: the high-quality aluminum material is powder-coated with dirt repelling nano-surface. Added to this is STEINEL's perfected sensor technology to guarantee years of reliable operation.

### Settings

- Detection zone can be limited by fitting the shrouds supplied
- Light 'ON' time and twilight threshold are easy to set by dial under removable decorative ring.

### Main features of the L 262 S

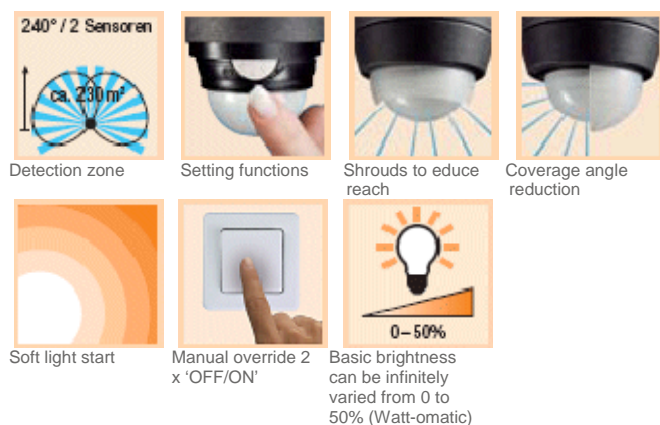

### Technical Data L 262 S

(Art.-No.: **alu-silver 646417**, Art.-No.: **alu-anthracite 646519**)

Dimensions (h x w x d)	300 x 200 x 200 mm
Output / light bulb	100 W max. / E 27
Voltage	230 – 240 V / 50 Hz
Angle of coverage	240° with sneak-by guard, 180° angle of aperture
Reach	12 m max. (temperature-stabilized)
Twilight setting	2 - 2000 lux
Time setting	15 sec. – 15 min.
Brightness control	0 - 50% (Watt-o-matic)
Permanent light	4 hrs. selectable
Enclosure type	IP 44
Protection class	II
	Subject to technical modifications