

L 308 S



First-class technology in trendsetting design

The L 307 S and L 308 S lights combine modern, fascinating design with new, groundbreaking sensor technology. In terms of looks, it's not the sensor that stands out, but the design of the light itself. This is made possible by a new, miniaturised sensor unit with superb, innovative technical features.

Boasting a 4-segment sensor system and precision mirror optics for a long focal length, the sensor provides even, high-resolution 360° all-round coverage in a radius of 8 m - unprecedented in this class of sensor. This leaves no important area of a property unprotected: neither the garage, the front entrance, nor the garden path. The operating concept has also been completely redesigned. To permit rapid, intuitive adjustability of the sensor electronics to individual user needs, the entire sensor module can be taken out of the light, set in your own time, put back again and made theft proof. No separate operating instructions are necessary. The user is also provided with a number of practical technical features: light soft start / soft end, 25% basic brightness, also only up to midnight depending on setting, and the option, which many customer want, of using low-energy bulbs.

Adjusting the settings at dusk or when it's dark is not a problem either because the light comes "ON" as soon as the sensor is removed.

Typically Steinel, the workmanship of these lights, in their stylish matt finish with a base in high-grade die-cast aluminum as well as hand-blown opal glass shade, meets the highest demands on quality.

Cutting-edge microprocessor control provides functions that leave you wanting for nothing:

- The integrated soft light start feature produces a pleasant lighting effect and prolongs the life of the bulb by gradually increasing the output of connected lights over a period of one second when they are switched "ON". The electronics are equally as gentle on the light when it is switched "OFF".
- Brightness control (Watt-o-matic) – an adjustable basic brightness of 25% allows you to create permanent light full of atmosphere when it's dark. When movement is detected, the light switches to full power for the time selected. This function can be limited to midnight.
- Manual override (4h) by operating a mains switch connected in the power circuit.
- For the first time, it is now also possible to fit a low-energy bulb.

Detection zone



Setting capabilities

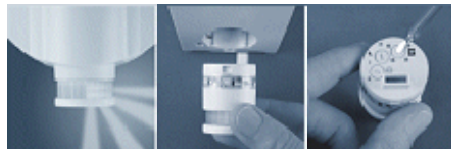

Programme setting



Technical Data L 308 S

Prod. No.	655310
Dimensions (h x w x d)	326 x 230 x 114 mm
Voltage	230 – 240 V / 50 Hz
Output	100 W max. / E 27 (low-energy bulb possible)
Angle of coverage	360° with sneak-by protection
Reach	8 m all round
Sensor system	2 detection levels, 512 switching zones
Time setting	5 Sec. – 15 Min
Twilight setting	2 – 2000 lux
Enclosure	IP 44
Protection class	II
Brightness control	25 % (Watt-o-matic)
Permanent light	selectable 4 h
Special features	Including soft light start and 4 programme settings geared to practical needs Subject to technical modifications